



CMHA Return to Phase 2 Safety Plan

Memorial Arena

December 4th, 2020

This Update is in response to Dr. Bonnie Henry's Provincial Health Order (PHO) released on December 4th, 2020 which returns all youth sport to Phase 2 requirements. CMHA would ask that the City of Cranbrook consider this updated Safety Plan. Our proposal is aligned with all current Provincial Health Authority, ViaSport, BC Hockey and BCRPA regulations relating to Covid and Return to Play.

CMHA reserves the right for coaches and volunteers to remove any player from the facility that they deem to be a safety risk.

CMHA will comply with these regulations as follows:

- **Spectators / "Patrons"** (see PHO on Gatherings and Events, December 4th, 2020 for definition) will not be permitted within the arena at this time.
- **Cohort** – Cohort's are not permitted under Phase 2 Regulations.
- **Social Distance** – Social Distancing means a three (3) metre spacing between individuals.
- **Covid Ambassador** – each team (if shared practice) will name at least one Covid Ambassador who must have a visible presence. This individual will oversee adherence to the return to play plan, facility guidelines, and ensure that COVID protocols are being followed. Failure of the Ambassador to oversee adherence to the return to play plan, facility guidelines, and ensuring the COVID protocols are being followed could result in a loss of booking privileges to the renter or organization.

Practices:

- See **Appendix A and B** for permitted numbers.
- All people entering the facility and their respective roles must be recorded along with contact info for each game in the CMHA Practice Form PDF.
- Face coverings must be worn at all times within the facility.
- Masks may only be removed by players and coaches when leaving the Trophy Case area directly to the field of play (ice surface).
- 3 metre social distancing must be maintained at all times (including playing surface).



- Volunteers must remain in the designated areas within the facility as follows:
 - Coaches, HCSP will be permitted on the Ice Surface.
 - Volunteers will be permitted to stand at the north end of the building by the glass or in Section B behind the Visitor Players Bench. 3 metre spacing between volunteers must be maintained unless they share the same home.
 - All other areas within the stands will be off limits at this time.

Games/Scrimmages:

- Not permitted under current Phase 2 Guidelines.

Arrival:

- It is preferred that all players arrive at the arena fully dressed or as close to fully dressed as possible.
- Teams will only be allowed to enter the arena 15 minutes prior to their scheduled ice time and will have to exit the arena within 15 minutes from the end of the scheduled ice time.
- Strict adherence to the 15-minute guidelines will be required to not negatively impact other user groups. Failure to do so will may affect CMHA's ability to book future ice with the City.
- Participants will arrive wearing a mask or facial covering. Masks must remain on at all times (except while on the playing surface).
- Participants will line up at the **Front Entrance** accessed from the South parking lot along 2nd Street N.
- Each Team will provide a safety check-in person stationed inside the Entrance to perform the following:
 - Record the name and contact info of everyone entering the arena and hold onto the records for 30 days for contact tracing.
 - Each player will only be permitted to enter if:
 - Temperature is within the acceptable range.
 - Completed TeamSnap Health Check or Fillable Game Day Form.
- Once check-in is complete, players will proceed in single file directly to the appropriate pre-ice area (Trophy Case Area) while maintaining social distance. Players will be permitted to put on helmets, skates and gloves within this area.
- To minimize physical contact, coaches and on-ice volunteers will not tie skates for participants within the facility but players may get assistance from approved masked volunteers.
- Players are each permitted to bring in one or two water bottles that must be filled at home. Bottles must have the players name clearly displayed.



Exit Ice and Building Procedure (Southwest Exit):

- At the end of the session, participants must exit the ice, single file, back to their spot in the pre-ice area. Participants must leave through the South West Exit adjacent to the Trophy Case Area within 15 minutes, so the next group can enter the building.

Entry to Ice (field of play):

- Safety check in person will direct participants to the appropriate areas once inside the facility.
- Masks may be removed and left in their seat in the pre-ice area immediately prior to putting on helmets and heading to the ice.
- Players should maintain social distancing at all times.

On-Ice Procedure

- There is a maximum of 20 players total and 5 coaches permitted on the ice at one time.
- No game play permitted – practices and skill sessions only
- Players benches are off limits at this time
- All drills will utilize social distancing and will require groups to be broken into stations to minimize physical contact.

Coaches, volunteers, officials:

- Will provide contact tracing info, have temperature checked, and confirm they are symptom free.
- Will do their best to ensure that social distancing rules are followed when required.
- Will wear a face covering when social distancing can not be achieved. This applies to assisting players with equipment, attending to injured players, etc.
- Will put on skates and/or equipment within the designated approved areas.

Suspected illness with any Covid related symptoms:

- All safety volunteers are encouraged to maintain social distancing. If for any reason they are required to be closer than 3 meters from a potentially ill participant, they will be required to wear a face mask, gloves and eye protection.
- Participant will be asked to go directly off the ice and up into the isolation area located in the warm viewing room at in the upper level of the southeast corner of the building.
- Parents will be contacted and be asked to pickup and take their child directly to the hospital for professional evaluation.
- If a positive Covid case is reported, CMHA will contact Interior Health and follow their guidance.



- All decisions relating to a positive Covid case will be made by Interior Health only.

Additional Facility Information:

- Sanitization stations with hand sanitizer will be located at each check-in station and within pre-ice areas.
- South end public washroom usage will be permitted but will be restricted to only 2 people per washroom at a time.
- Dressing rooms will remain off limits.

Additional Safety Rules:

- **NO SPITTING (including water from water bottles) anywhere inside of the facility including on the ice surface.**
- No sharing of water bottles.
- No horseplay of any kind.
- Any player that feels sick or unwell **MUST** stay home.

Discipline Policy:

- A failure to comply with any of these guidelines will result in the following minimum disciplinary measures:
 - First Offence - Verbal Warning
 - Second Offence – Player and/or Teams will miss the next scheduled ice time and parents will be notified.
 - Third Offence – Player(s) will be removed from participation indefinitely and the matter will be brought to the CMHA Discipline Committee for disciplinary action.



Appendix A- Approved Numbers (age 9 and up)

- 20 Players
- 5 Coaches
- 1 Manager
- 1 Covid Ambassador
- 1 Covid Screener Volunteers

28 Total

- The list above provides the maximum group size for all City of Cranbrook arenas.
- HCSP must fall into one of the bottom 4 roles as shown above.
- Arena Staff are not included in the total number.
- Teams are encouraged to minimize their group sizes as much as possible. The numbers above are maximums, and roles can not be replaced or substituted with other non-essential roles to push the limits to 28.



Appendix B- Approved Numbers (Under 9 and Beginner Female Group ages 5-13)

- 20 Players
- 5 Coaches
- 1 Manager/Off-ice volunteer
- 1 Covid Ambassador/Off-ice volunteer
- 2 Covid Screener Volunteers/Off-ice volunteer
 - A minimum of 2 Adults Must always be present when in the presence of youth.
 - Must remain in the designated viewing area as determined by the facility

29 Total

- Shared Practices are no longer permitted at this time.
- The maximum group size for all City of Cranbrook arenas is 29 (full participants plus essential event staff).
- Arena Staff are not included in the (29) total number.
- Teams are encouraged to minimize their group sizes as much as possible. The numbers above are maximums, and roles can not be replaced or substituted with other non-essential roles to push the limits to 29.

Appendix C - Memorial Arena

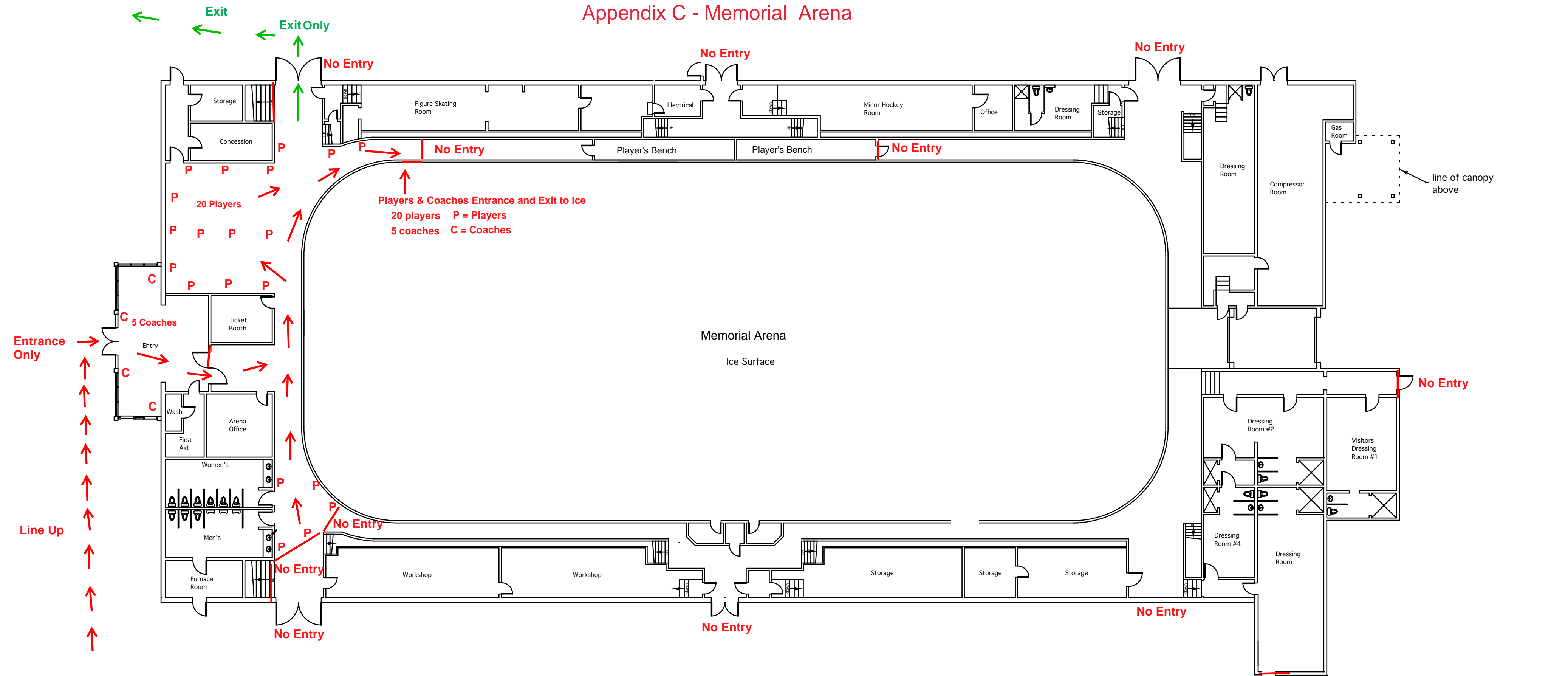

MAIN FLOOR PLAN

SCALE 1/16" = 1'-0"

5			<div>11506 Highway 3a Sanca, BC V0B 1A2 Phone: 250-223-8080 Fax: 250-223-8080</div> <div>#9642 Clearview Road Cranbrook, VIC 7E2 Phone: 250-427-4578 Fax: 250-427-4578</div> <div>Christine Ross ARCHITECT</div>	Christine Ross Architect MAIBC	Project CRANBROOK MEMORIAL ARENA	Sheet Title MAIN FLOOR PLAN				Sheet No. A-1
4										
3										
2										
1										
NO	DATE	DESCRIPTION					Project No.	Date: July, 2011	Scale: 1/16" = 1'-0"	