



2025 - 2026
Hockey TV

Managers Meeting



Flo TV

- All AEHL and AFHL teams are required to stream games on hockey TV.
- OOAA has 4 dedicated Encoders (2 at VRC, 1 at Murray and 1 SSR).
 - Encoder is really a computer.
- All have dedicated keyboard and screens.
- Set-up is the same for all rinks.
 - Encoder
 - Screen
 - Mouse and keyboard
 - Camera
- All rinks have hard wired internet connections
 - Murray was added Sept 2025 includes Wi-Fi

Locations

- Viking - Both stored in North East Corner
 - Ask Rink Attendant to let you in
- Murray
 - Dressing room #2
 - OOAA has storage locker
 - Rink staff will unlock
- SSR
 - Sean and staff will have it ready





Turning On

- Plug in all devices.
 - Including camera
- Plug camera into Encoder.
- Plug in Ethernet cable.
- Password to unlock all computers:

FHencoder

Home Screen

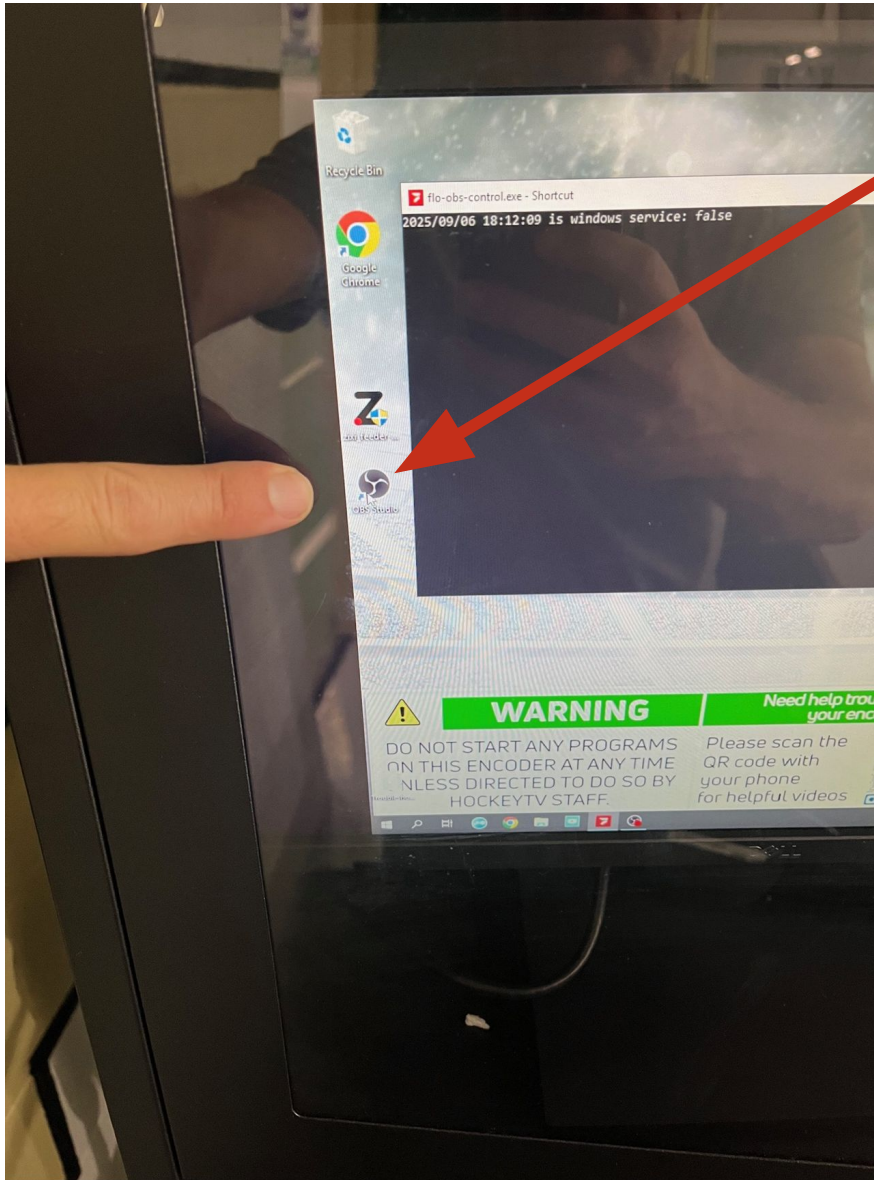

- Changed the app for 2025
- OBS Studio
- Double click to open up

App Home Screen

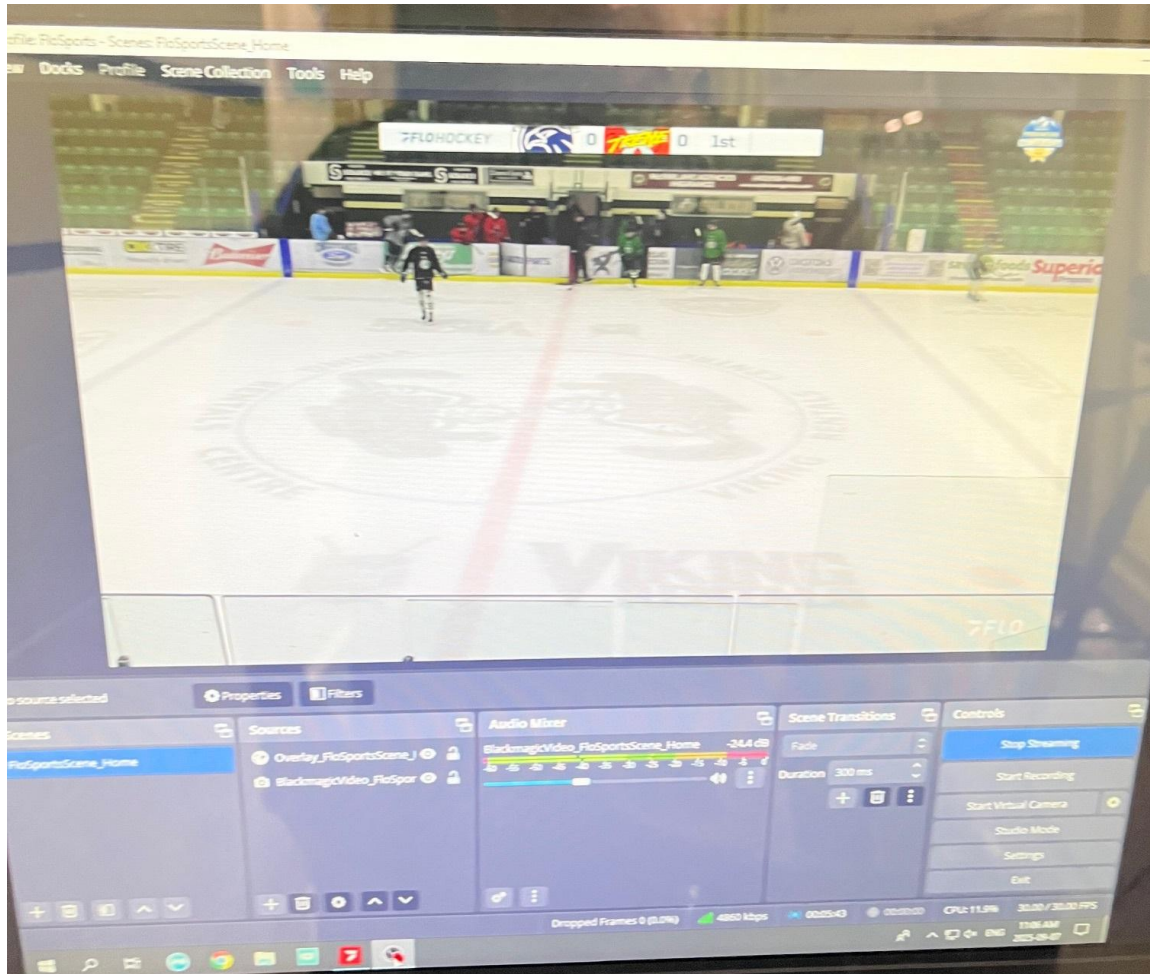

- New home screen for 2025

System is ready

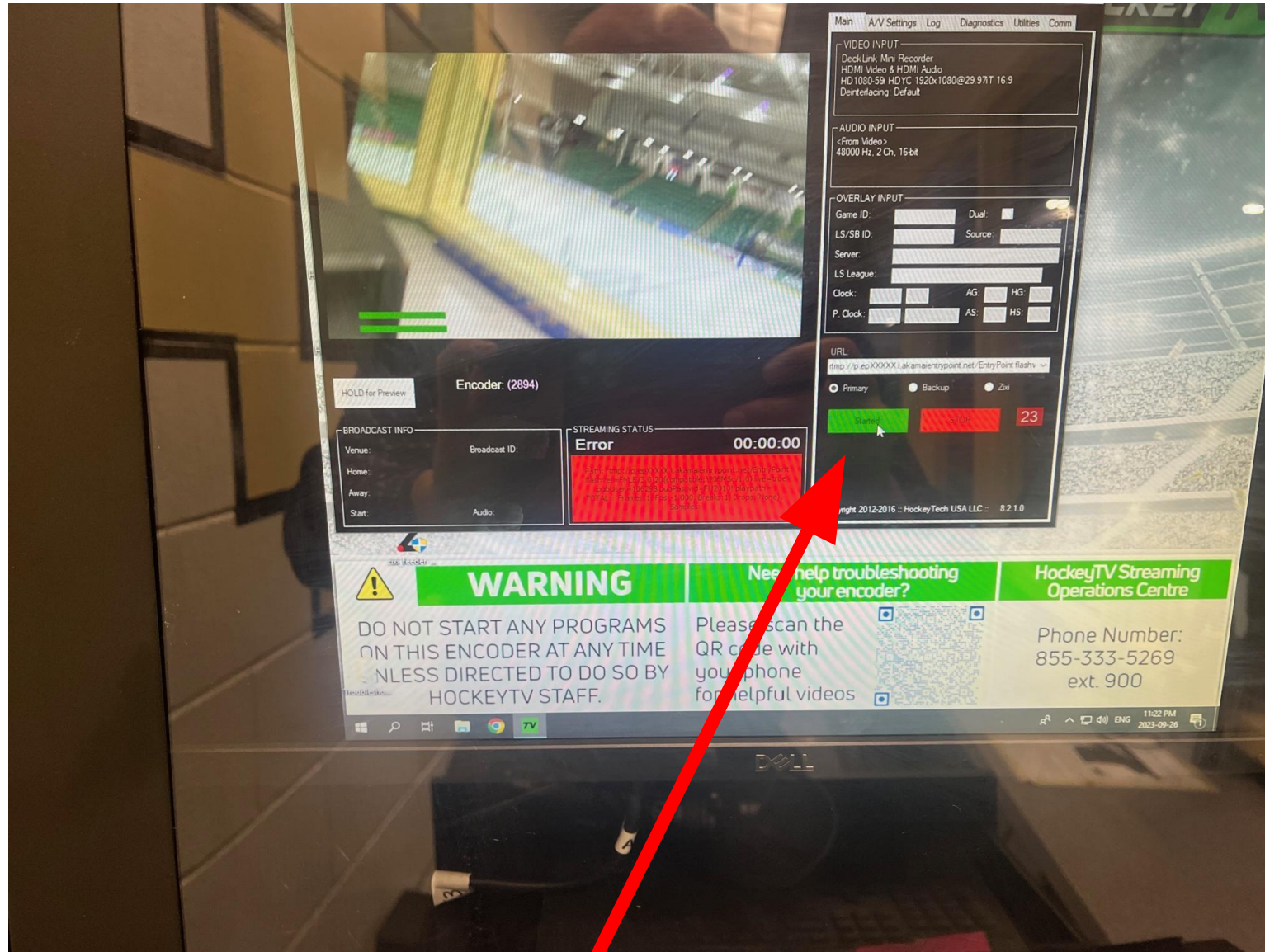

- To go live you click on start
- To end click on stop



Game Set-up

- Once you have powered everything up.
- Call Hockey TV at least 60 minutes before to test feed
 - 1 855 333 5269
- Provide them the following:
 - Team & League
 - Encoder # and Name
 - Viking Gold - #2894 OOAA Viking Gold
 - Viking Green - #2895 OOAA Viking - Green
 - SSSR - #3248 - OOAA SSSR
 - Murray- #3024 OOAA Murray Arena
- **USE THE 4 DIGIT NUMBER - Number is on the 3 carts and monitor at SSSR**
- Once they confirm you are good to go



Game Time

- Once live beware
 - **MIC is now HOT!!!**
- Once MIC is on the home team is liable for all language and comments made. League can suspend coaches.
- Warm-up
 - Can film home team only
- Intermission
 - Centre Ice
- Do not turn off feed between periods
- End of game click stop feed
- Return equipment to storage area



Things to be aware of

- Set-up 1 hour before
 - They will start to call your team contact
- Games not online at the start will be pulled from FloTV
- Internet
 - We are at the mercy of the buildings we are in
 - We CAN'T call someone in
 - The rink staff DON'T know how to reset
- Issues
 - Report any issues or concerns
 - Fraying wire
 - Broken part